

ESTABLISHING A **NEW STANDARD** IN THE COMMERCIAL REFRIGERATION INDUSTRY.

Energy efficient, environmentally friendly, featuring spark-free components, low refrigerant charge and the most attractive product display.



KEY FEATURES



- **Eco-Friendly HC Natural Refrigerant**
New R290 HFC-free refrigerant gas that reduces environmental impact and increases efficiency.



- **Electronic Temperature Controller**
Patented ETC1H electronic controller assures optimal refrigeration performance through precision temperature control, and intelligent control for defrost cycle, compressor & other component functions.



- **Electronic Fan Motors**
Enhances performance and efficiency. Uses only a fraction of the energy and offers longer life expectancy than industry standard shaded-pole motors.



- **Newly Designed Condenser**
New condenser featuring a joints reduction down to zero increasing long term refrigeration reliability and safeguarding against any system leaks.



- **LED Efficiency +220 LUX Minimum Output**
New 5th generation constant power ultra-high efficiency LED uses lowest energy possible, with highest light output.



- **Spark-Free Refrigeration Components**
All HC models will have spark free refrigeration components for optimal safety, per UL requirements.

CERTIFICATIONS



DOE 2017

COMMERCIAL REFRIGERATOR
AND/OR FREEZER
5242

NSF/ANSI 7 COMMERCIAL REFRIGERATOR
AND/OR FREEZER
2017

ESTABLISHING A **NEW STANDARD** IN THE COMMERCIAL REFRIGERATION INDUSTRY.

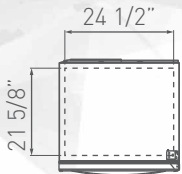

TOP VIEW

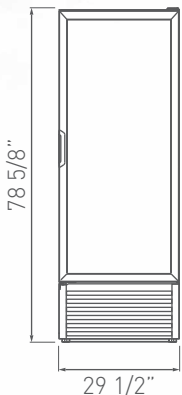

FRONT VIEW

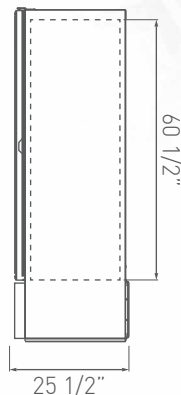

SIDE VIEW

PRODUCT VIEWS

Dimensions rounded up to the nearest inch or millimeter. Specifications subject to change without notice.

EXTRA OPTIONS

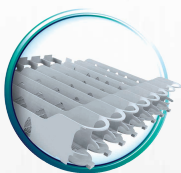

Interior merchandising options include gravity kits, Sandwich Trays and freezer baskets



Casters and Legs Available



Lock options with different capabilities available

Customer Service: 866-548-5770 | WWW.IMBERAFOODSERVICE.COM

Three year limited warranty is included on all parts and labor. An additional two year warranty is issued on the compressor (USA & Canada only).

Operators must follow installation and operational guidelines per Imbera Users Manual and each cooler must have its own power supply, or warranty will be void.

TECHNICAL SPECIFICATIONS

Exterior Dimensions

| | | |
|----|---------|---------|
| H: | 78 5/8" | 2000 mm |
| W: | 29 1/2" | 750 mm |
| D: | 25 1/2" | 660 mm |

Interior Dimensions

| | | |
|----|---------|---------|
| H: | 60 1/2" | 1536 mm |
| W: | 25 1/2" | 647 mm |
| D: | 21 5/8" | 549 mm |

Usable Interior Capacity

| | | |
|----|---------|---------|
| H: | 60 1/4" | 1257 mm |
| W: | 24 1/4" | 617 mm |
| D: | 19 1/6" | 484 mm |

Usable Volume

| |
|----------------------|
| 19.2 ft ³ |
| 543.6 lts |

Capacity 20 oz. Bottle

Flat: 240

Doors

1

Door Construction

Standard Black Plastic Frame

Shelves

5

Shelf Size & Gauge

| | | |
|----|---------|--------|
| W: | 24 3/4" | 630 mm |
| D: | 19 5/8" | 497 mm |

REFRIGERATION PERFORMANCE DATA

Refrigerant R290

2.29 Oz

Energy Consumption

1.820 kWh/day*

Compressor Power

1/4 HP

Condenser

Finless, (low maintenance)

Evaporator

Dynamic

Thermostat Setting

Default

Cut-Out

32°F (0°C)

Cut-In

44.6°F (7°C)

Noise

55.30 dB

ELECTRICAL DATA

Power Supply

115v / 60 Hz

AMPS

7.0 kWh/day

Cord Length

118'
3000mm

Lighting

312 Lux output
9 modules
8 LED per module

Plug Type

PC-731 ⓘ

Controller

Imbera ETC1H controller
Pre-programmed temperatures

LOGISTIC DATA

Trailer Loads

| | |
|------|----|
| 53': | 60 |
| 40': | 42 |

Unit Weight w/packaging

| |
|-----------|
| 240.4 Lbs |
| 109.1 kg |

Dimensions w/packaging

| | | |
|----|---------|---------|
| H: | 82 5/8" | 2100 mm |
| W: | 32 1/4" | 820 mm |
| D: | 29 7/8" | 760 mm |

*Energy consumption based on ANSI/ASHRAE Standard 72-2005.

BMAD System (Low maintenance high performance).
Dimensions rounded up to the nearest inch or millimeter.
Specifications subject to change without notice.